

The Estate Agent People Recommend



11 Harrison Close,
Twyford
RG10 0LL



WentWorth Estate Agents have pleasure in offering to the market this TWO/THREE BEDROOM SEMI-DETACHED PROPERTY within a cul-de-sac on the popular Waltham Chase/Broad Hinton development with NO ONWARD CHAIN.

The property is approximately 0.6 miles away from Twyford village and mainline train station serving London Paddington and Reading.

Ground Floor accommodation comprises Covered Entrance porch, Living room, Kitchen/Breakfast room with fitted appliances, Dining Room/Bedroom with patio doors into the garden and Garage.

First Floor Accommodation comprises of Two Double Bedrooms and Family Bathroom.

Further benefits include double glazed windows, private laid to lawn garden, garage, parking in front of the garage,

EPC Rating E

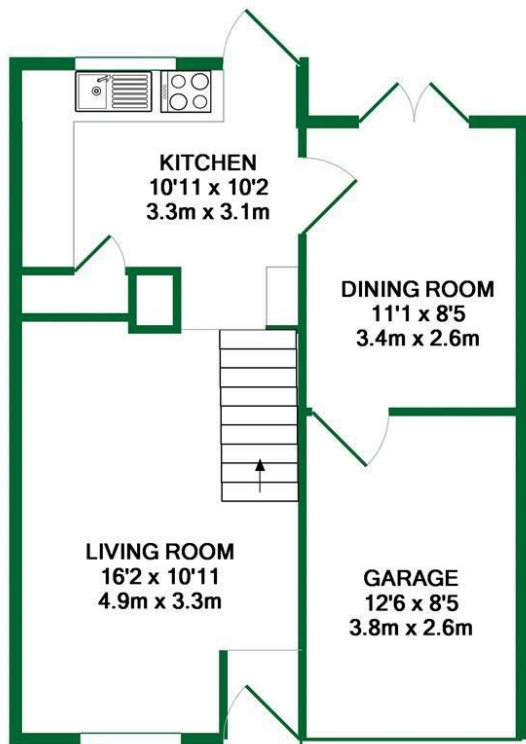

GROUND FLOOR

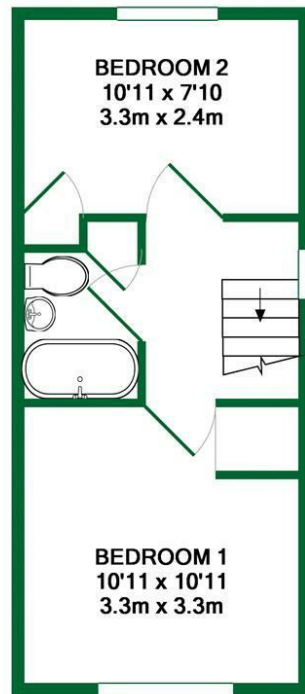

1ST FLOOR

TOTAL APPROX. FLOOR AREA 743 SQ.FT. (69.0 SQ.M.)

Whilst every attempt has been made to ensure the accuracy of the floor plan contained here, measurements of doors, windows, rooms and any other items are approximate and no responsibility is taken for any error, omission, or mis-statement. This plan is for illustrative purposes only and should be used as such by any prospective purchaser. The services, systems and appliances shown have not been tested and no guarantee as to their operability or efficiency can be given
 Made with Metropix ©2019

ACCOMMODATION

- SEMI DETACHED
- TWO DOUBLE BEDROOMS
- DINING ROOM / THIRD BEDROOM
- GARAGE
- PARKING FOR ONE CAR
- QUIET CUL-DE-SAC
- WALKING DISTANCE TO TWYFORD VILLAGE AND MAINLINE STATION
- NO ONWARD CHAIN



The Old Butchers, 15 High Street, Twyford, Berkshire, RG10 9AB
 t: 0118 934 0027 e: twyford@wentworthea.com



wentworth_ea



wentworthestateagents

IMPORTANT: we would like to inform prospective purchasers that these sales particulars have been prepared as a general guide only. A detailed survey has not been carried out, nor the services, appliances and fittings tested. Room sizes should not be relied upon for furnishing purposes and are approximate. If floor plans are included, they are for guidance only and illustration purposes only and may not be to scale. If there are any important matters likely to affect your decision to buy, please contact us before viewing the property.